

# CITY OF MURRAY CONTROL MONUMENT CARD

DESIGNATION: D5 2010 B  
TYPE: CITY DISK SET IN DRILL HOLE IN CONCRETE  
DATE SET: JUNE 2010 QUAD: MURRAY, KY.  
HORIZONTAL DATUM: NAD-83 (NSRS 2007)  
VERTICAL DATUM: NAVD-88 (GPS) ZONE: KY. S 1602

NORTHING: 1754705.267 FT STATE: KENTUCKY  
EASTING: 887756.116 FT COUNTY: CALLOWAY  
ELEVATION: 537.29 FT (GPS)  
LATITUDE: N 36°37'09.02743" LONGITUDE: W 088°18'53.43070"  
SCALE: 1.000022681 CONVERGENCE: -1°33'19.72816"  
PLANE AZI. TO AZI. MARK:

To Reach: Located at the intersection of US 641 and  
Arcadia Circle.

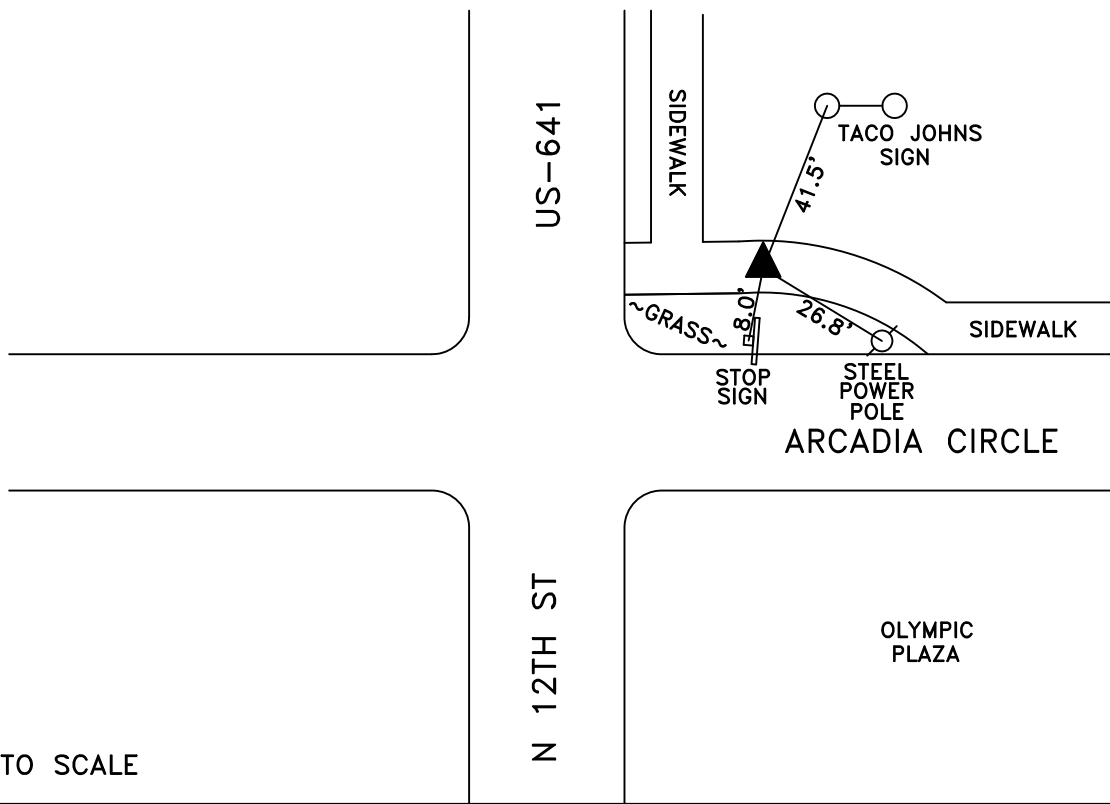

GRW Aerial Surveys, Inc.  
801 Corporate Dr. Lexington Ky. 40503  
(859)223-3999